

松霖一字型淋浴房

上铝材

置物玻璃

固定玻璃

下铝材

浴帘布

SOLUX

安装攻略

封底

封面

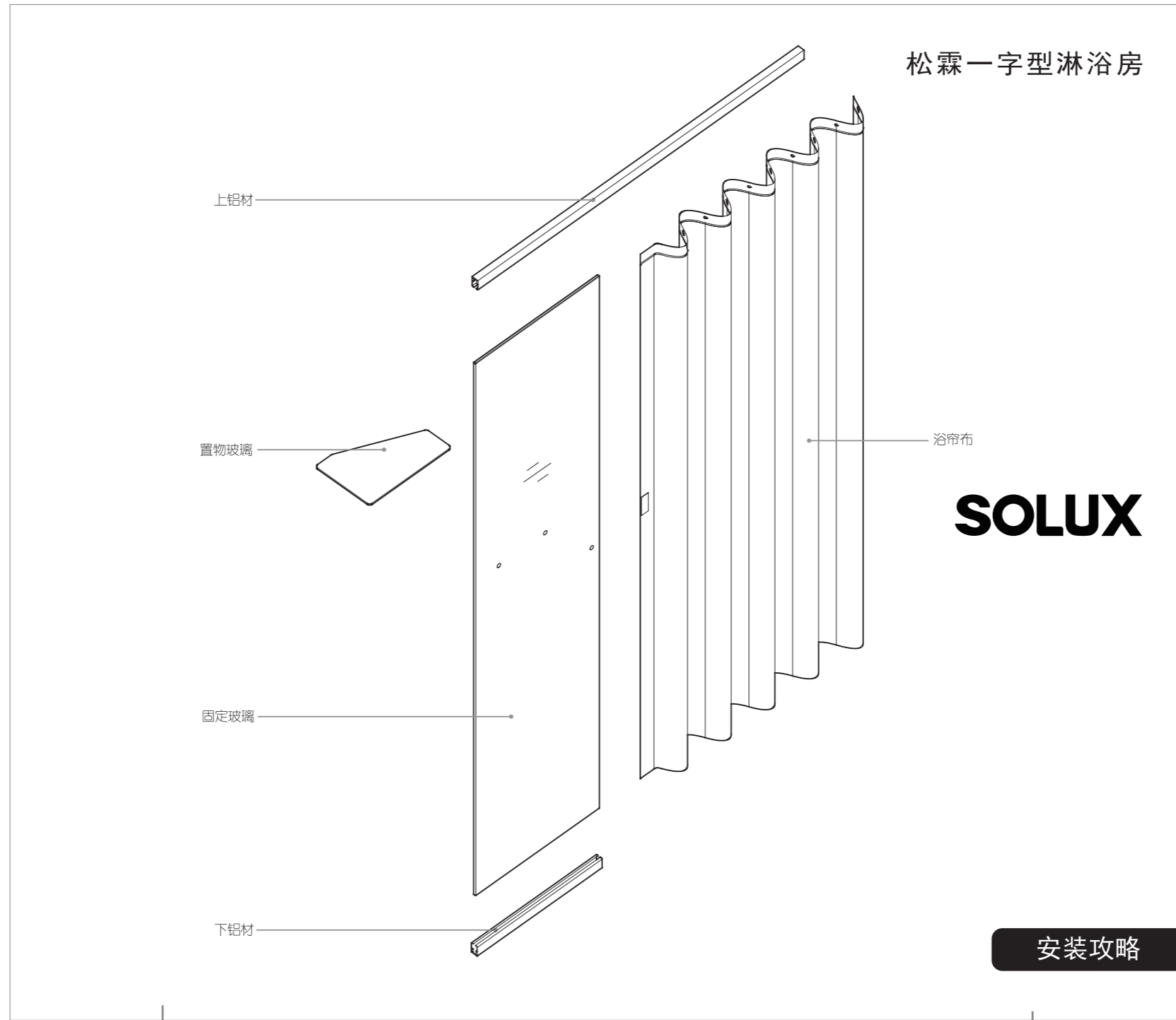

安装准备

自备安装工具

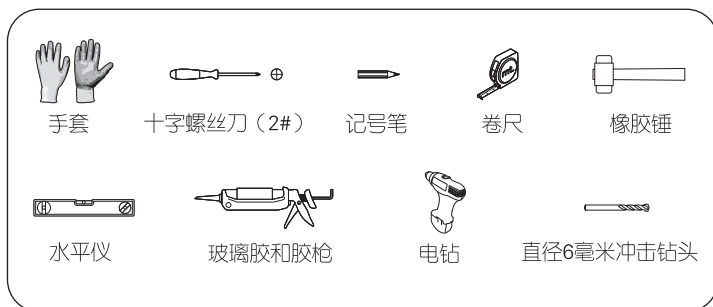

SOLUX配备的安装工具

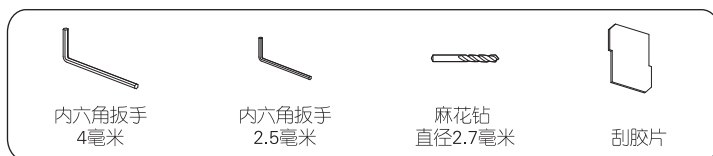

安装注意事项

1. 本产品有A012和A174两款型号，A012的安装范围120-160厘米，A174的安装范围160-200厘米。
2. 安装淋浴房过程中请佩戴手套。
3. 本产品左右都能安装，请确定安装方向，本说明书固定玻璃是装在左边，右边同理。
4. 安装前，请确认安装位置地面上有挡水石且挡水石内外有地漏。
5. 在墙上钻任何孔时，请确保在您准备钻孔的地方没有隐蔽的管道和电缆。
6. 当您在钻孔、安装时，请注意安全。
7. 安装过程中有疑问请联系SOLUX售后服务电话：400-667-6665。

零件清单

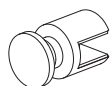

置物玻璃夹 2x



墙夹 2x



挂钩磁铁组件 1x

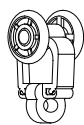

滑轮 11x



固定座 1x



固定块 1x



上堵头 1x

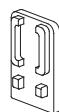

下堵头 1x



活动卡圈 12x

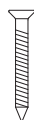

3.5 x 35 螺钉 4x



膨胀管 4x

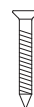

3.5 x 19 螺钉 3x

安装 步骤

01 固定下铝材

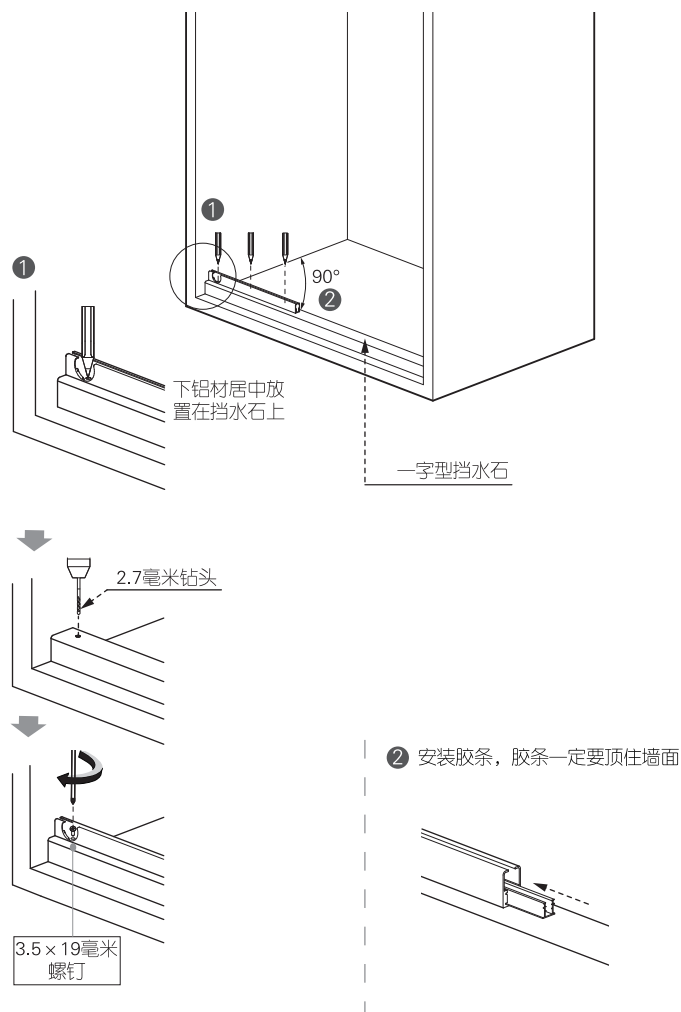

02 安装固定玻璃

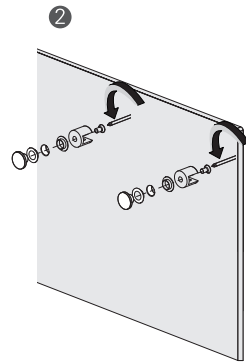
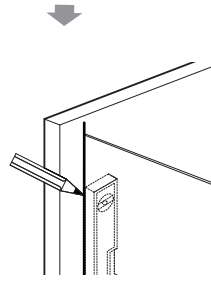
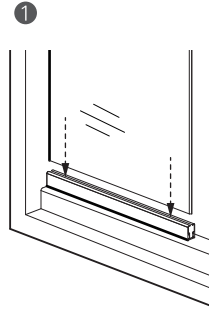
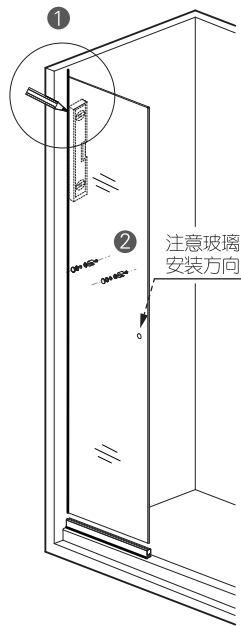

先取下夹子上的透明垫片并收好
注意：玻璃夹的螺纹孔朝下

03 安装置物玻璃

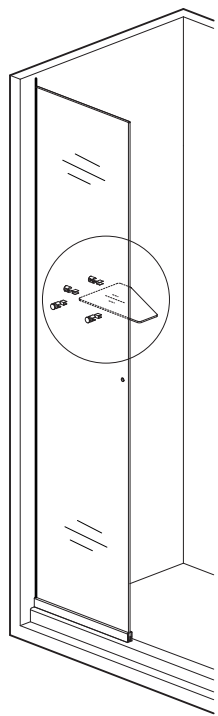

注：请确认安装位置的墙里没有水电管道，避免墙面钻孔时损坏水电管道。

① 确定孔位

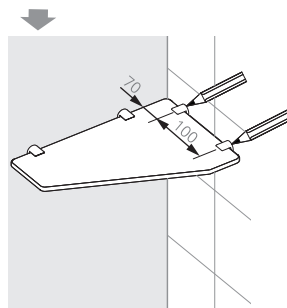
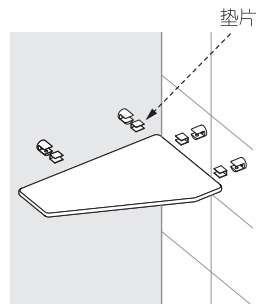

置物玻璃保持水平

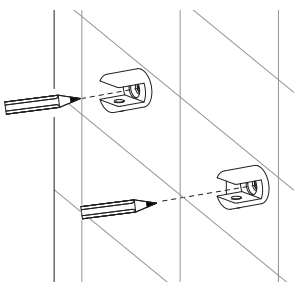

取下透明垫片并收好
注意：螺纹孔朝下

② 固定墙夹

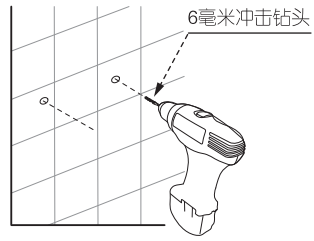

注：钻孔深度为35-40毫米。

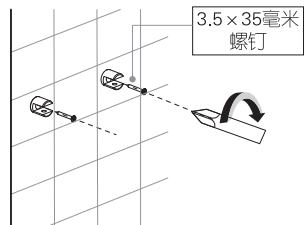
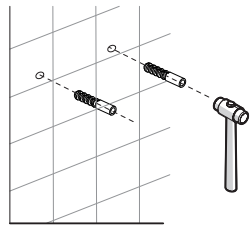

③ 安装锁紧固定玻璃

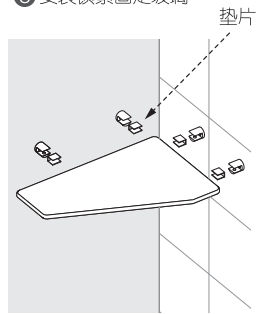

注：固定玻璃紧贴墙面

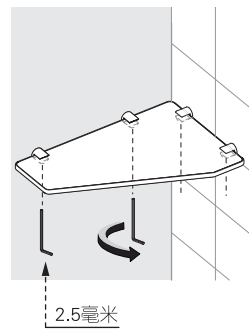

04 安装挂钩磁铁

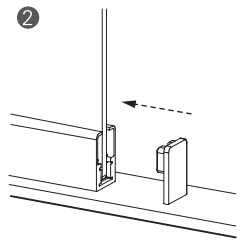
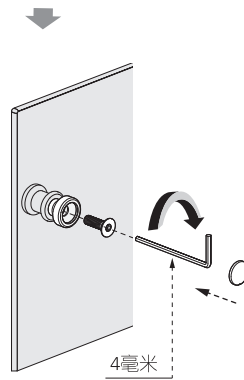
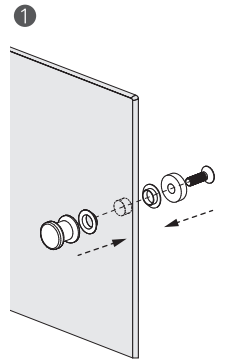
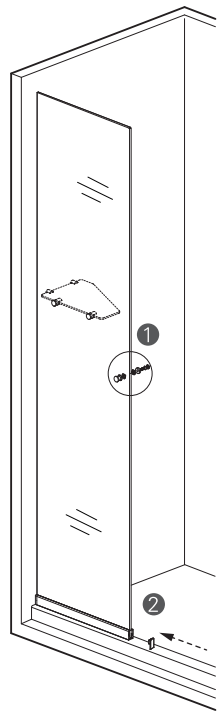

05

墙壁画线

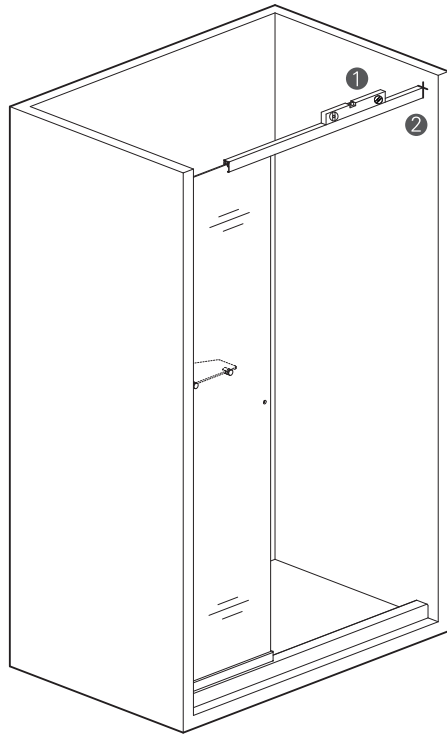

注：请确认安装位置的墙里没有水电管道，避免墙面钻孔时损坏水电管道。

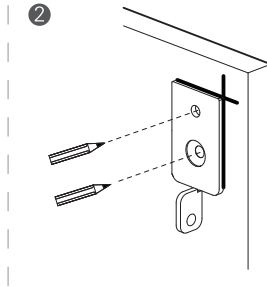
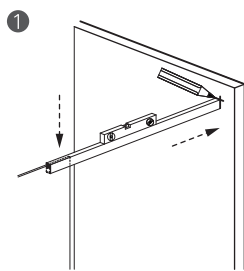

06 安装固定座 及固定块

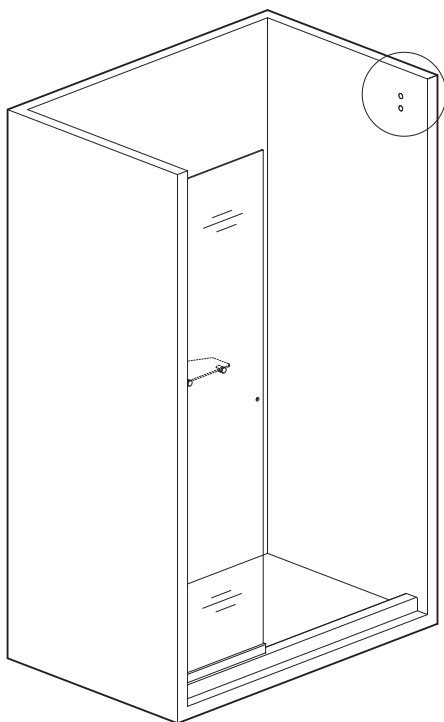

6毫米
冲击钻头

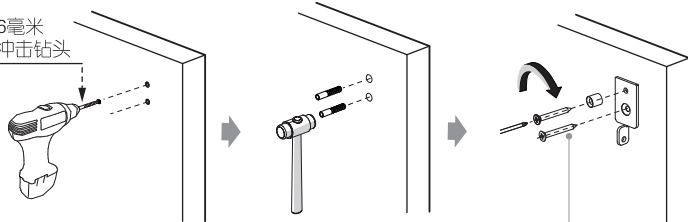

注：钻孔深度为35-40毫米。

3.5 × 35毫米
螺钉

07

安装上铝材及滑轮

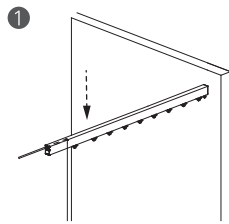
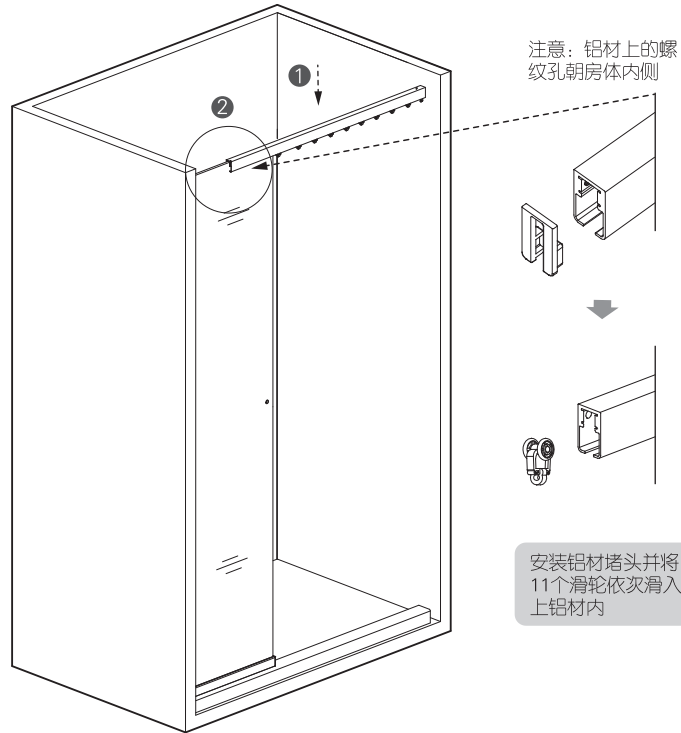

将装好堵头及滑轮的铝材卡入玻璃和墙壁上的固定块，并且铝材贴紧固定座。

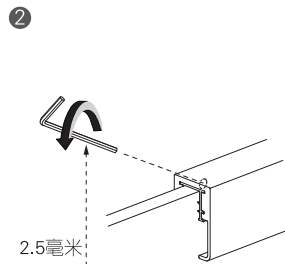

08

安装浴帘布

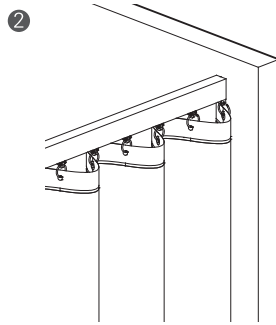
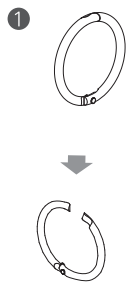
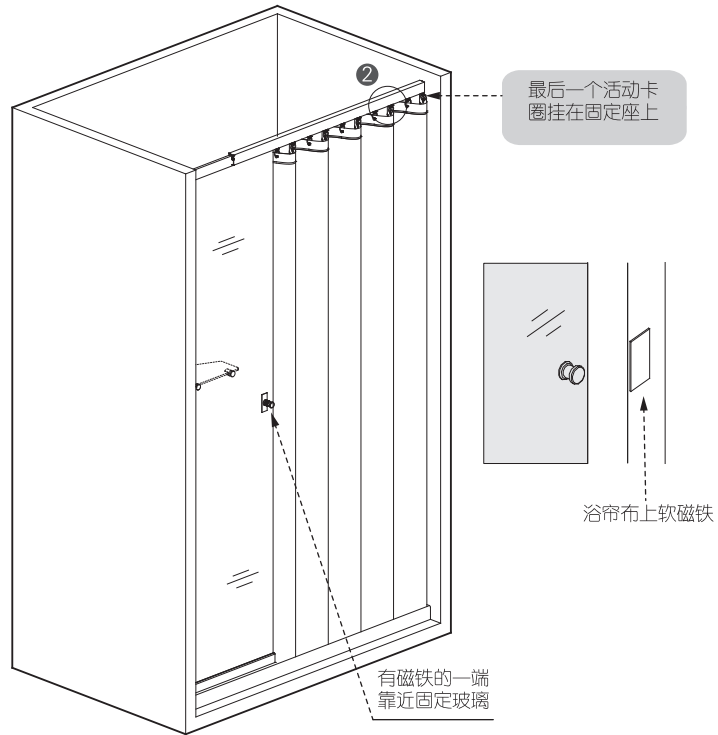

09

固定玻璃
下铝材打玻璃胶

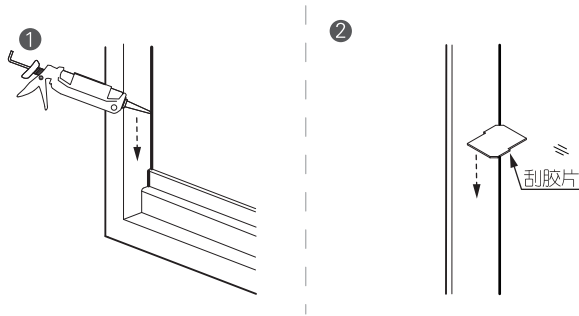
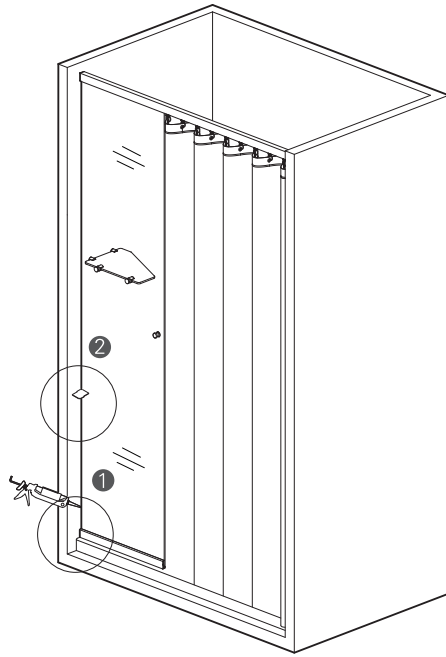

注：将打玻璃胶的位置擦拭干净并保持干燥（注意打胶的位置不能是潮湿的）。
打完玻璃胶要24小时后才能使用。

10

下铝材打玻璃胶

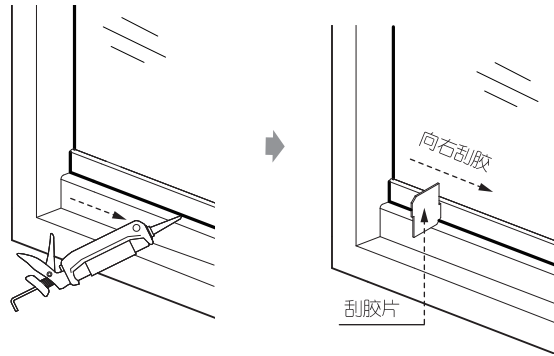
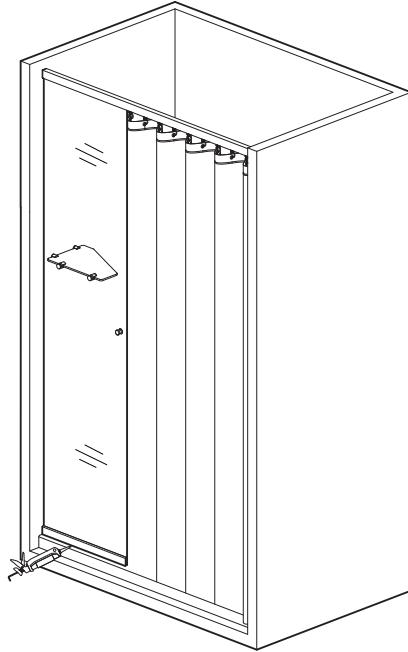

11

安装完毕

